

## REGISTROS CLASE D-400

### MANHOLE COVERS TYPE D-400

TAPA Y MARCO REDONDOS • CIRCULAR MANHOLE COVER AND FRAME

MATERIAL: FUNDICIÓN DÚCTIL GGG-50 • MATERIAL: DUCTILE IRON GGG-50



REFERENCIA REFERENCE	A	D	C	H	Peso Weight (Kg.)
RRR858MDDMADR	785	580	625	100	50
RTTRJ 60 DD GT	850	600	645	100	63

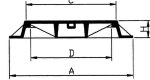

REFERENCIA REFERENCE	AxA	D	C	H	Peso Weight (Kg.)
RTTRJ 60 DD KV	850	600	650	190	89

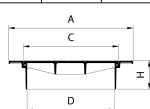

## REGISTROS CLASE C-250

### MANHOLE COVERS TYPE C-250

TAPA Y MARCO REDONDOS • CIRCULAR MANHOLE COVER AND FRAME

MATERIAL: FUNDICIÓN DÚCTIL GGG-50 • MATERIAL: DUCTILE IRON GGG-50



REFERENCIA REFERENCE	A	D	C	H	Peso Weight (Kg.)
RTTRJ 55 DC	635	550	585	40	40

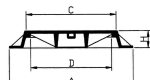

## REGISTROS CLASE B-125

### MANHOLE COVERS TYPE B-125

REGISTROS HIDRÁULICOS • HYDRAULIC MANHOLE COVERS

MATERIAL: FUNDICIÓN DÚCTIL GGG-50 • MATERIAL: DUCTILE IRON GGG-50

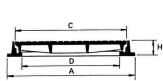

REFERENCIA REFERENCE	AxA	D	C	H	Peso Weight (Kg.)
RTCCJHI 30 DB	300	240	285	30	8
RTCCJHI 40 DB	400	325	385	30	11,5
RTCCJHI 50 DB	500	405	485	40	20
RTCCJHI 60 DB	600	510	580	50	30,5
RTCCJHI 70 DB	700	595	680	50	45,5
RTCCJHI 80 DB	800	700	780	55	67

MATERIAL: FUNDICIÓN GRIS GG-25 • MATERIAL: CAST IRON GG-25

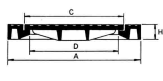

REFERENCIA REFERENCE	A	D	C	H	Peso Weight (Kg.)
RTCCJ30 GB CAMPSA	390	295	320	22	11
RTCCJ53 GB CAMPSA	600	530	565	30	31,5
RTCCJ58 GB MADRID	780	580	625	50	50

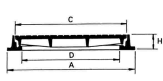
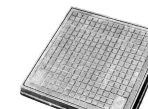

REFERENCIA REFERENCE	AxA	D	C	H	Peso Weight (Kg.)
RTCCJ24 GB	285	245	260	15	4
RTCCJ34 GB	385	340	360	16	9
RTCCJ47 GB	518	470	495	25	21
RTCCJ56 GB	605	560	585	24	31
RTCCJ58 GB MADRID	616	570	595	36	29
RTCCJ78 GB MADRID	815	785	790	40	58,5

REGISTRO ABSORBEDERO • AQUAKERB MANHOLE COVER



REFERENCIA REFERENCE	AxA	D	C	H	Peso Weight (Kg.)
RTCCJ8AB GB MADRID	870x780	580	625	210	62



REGISTRO PARA HIDRANTE • MANHOLE COVER FOR FIRE HYDRANT



REFERENCIA REFERENCE	AxA	D	C	H	Peso Weight (Kg.)
RTCCJ834 GB MADRID	1248x695	898x345	950x400	80	77

## REJILLAS CLASE C-250

### GRATINGSTYPE C-250

REJILLA SIN MARCO PARA CANAL • GRATING WITHOUT FRAME FOR WATER WAY

MATERIAL: FUNDICIÓN DÚCTIL GGG-50 • MATERIAL: DUCTILE IRON GGG-50



REFERENCIA REFERENCE	A	B	H	Peso Weight (Kg.)
RRGSJ 7525 DC	750	250	46	16
RRGSJ 7530 DC	750	300	46	24

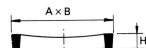

REJILLA CON MARCO • GRATING WITH FRAME



REFERENCIA REFERENCE	A	D	C	H	Peso Weight (Kg.)
RRGMJ 6635 DC	680x370	660x315	660x350	43	22,5
RRGMJ 6040 DC	620x415	570x370	600x400	43	26,5

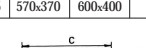

REFERENCIA REFERENCE	AxB	D	C	H	Peso Weight (Kg.)
RRGVI 3525 DC	425x325	350x255	385x285	32	15,5
RRGMJ 4023 DC	465x320	410x225	415x270	50	17,5

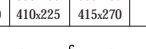

REJILLA PLANA • PLAIN GRATING

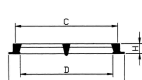

REFERENCIA REFERENCE	A	D	C	H	Peso Weight (Kg.)
RRGPJ 30 DC	320	255	300	38	12,5
RRGPJ 40 DC	420	350	400	38	21,5
RRGPJ 50 DC	520	450	500	38	33
RRGPJ 60 DC	620	550	600	38	48

## ARQUETAS PARA VALVULA ENTERRADA

### SURFACE BOXES

MATERIAL: FUNDICIÓN DÚCTIL GGG-50 • MATERIAL: DUCTILE IRON GGG-50

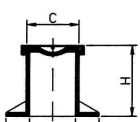

REFERENCIA REFERENCE	A	D	C	H	Peso Weight (Kg.)
RABRJ 09	240	90	100	170-285	10
RABRJ 12	185	95	110	165	4,5
RABRJ 1523	298x210	235x145	255x165	70	7

## ARQUETA DE ACOMETIDA HOMOLOGADA POR CANAL ISABEL II

### TELESCOPIC SURFACE BOX

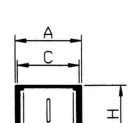

REFERENCIA REFERENCE	A	D	C	H	Peso Weight (Kg.)
RSBRJ 30	300x300	260	285	245-325	10

## SUMIDERO SIFÓNICO

### DRAIN

MATERIAL: FUNDICIÓN DÚCTIL GGG-50 • MATERIAL: DUCTILE IRON GGG-50

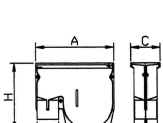
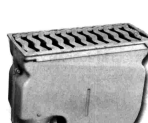

REFERENCIA REFERENCE	A	D	C	H	Peso Weight (Kg.)
RSUSI 15	680	185	255	570	80

## SIFONES

### TRAPS

MATERIAL: FUNDICIÓN GRIS GG-25 • MATERIAL: CAST IRON GG-25

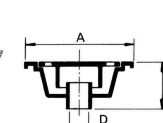

REFERENCIA REFERENCE	A	D	H	Peso Weight (Kg.)
RSFO 20	195	50	65	2,5